



BUSINESS EVENTS
VICTORIA
BC, CANADA



VICTORIA
CONFERENCE
CENTRE

LEVEL ONE

27,500 Sq Ft / 2,555 Sq M | 9 Rooms



VICTORIA
CONFERENCE
CENTRE

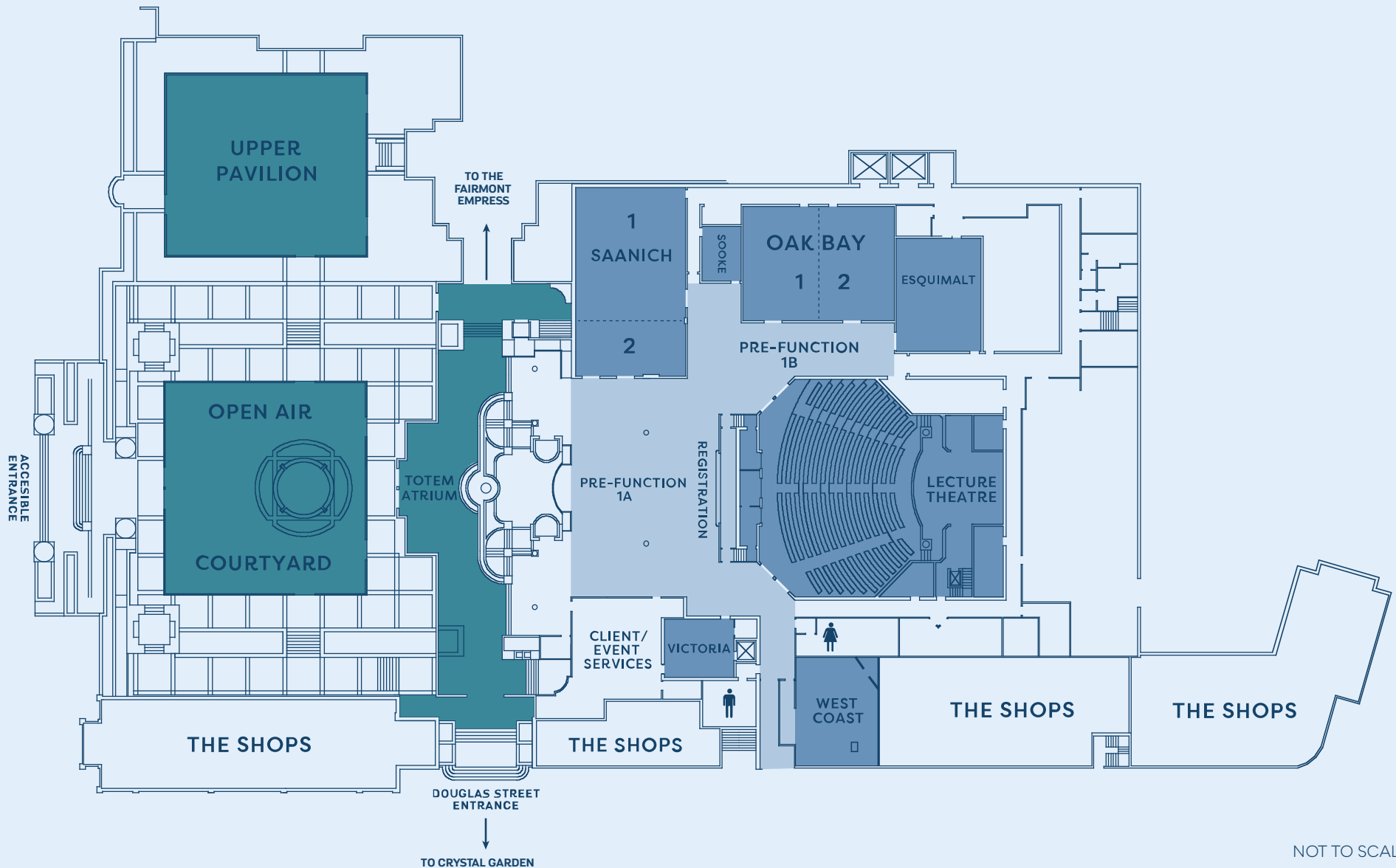

NOT TO SCALE

Room Name	Ft/In	Area Sq Ft	Area Sq M	Theatre	Classroom	Boardroom	Hollow Sq	U-Shape	Banquet	Cabaret	Reception	10x10	8x10	8x8	Tabletops	Poster Brd	
Included in the Level One Booking																	
Lecture	Stage to Ceiling ht. 19'	3,700	344	397	-	-	-	-	-	-	-	-	-	-	-	-	-
Theatre Stage	24' x 24'	576	54	-	-	-	-	-	-	-	-	-	-	-	-	-	-
Saanich	61' x 35' x 9'5"	2,135	199	227	132	-	70	60	150	102	225	10	10	12	25	24	
Saanich 1	43' x 35' x 9'5"	1,505	140	163	96	-	54	42	120	72	150	7	7	9	19	15	
Saanich 2	35' x 18' x 9'5"	630	59	54	36	28	-	-	30	24	65	3	3	4	6	6	
Sooke	18' x 13' x 9'5"	234	22	-	-	10	-	-	10	-	-	-	-	-	-	-	
Oak Bay	50' x 37' x 9'5"	1,850	172	169	96	-	56	42	120	90	200	8	12	14	20	20	
Oak Bay 1	37' x 25' x 9'5"	925	86	80	54	-	36	30	60	36	90	3	6	7	10	10	
Oak Bay 2	37' x 25' x 9'5"	925	86	80	54	-	36	30	60	36	90	3	6	7	10	10	
Esquimalt	38' x 28' x 9'5"	1,064	99	96	60	-	42	34	60	48	110	6	6	6	12	10	
Victoria	24' x 16' x 9'5"	384	36	35	18	20	-	-	20	12	40	-	-	-	-	-	
West Coast Room	Ceiling ht. 9'	980	91	50	36	20	18	21	30	24	-	-	-	-	8	8	
Pre-function	Ceiling ht. 9'10"	6,500	604	-	-	-	-	-	240	-	400	16	20	26	30	34	
Pre-function 1A	Ceiling ht. 9'10"	4,875	453	-	-	-	-	-	200	-	300	12	16	22	24	28	
Pre-function 1B	Ceiling ht. 9'10"	1,625	151	-	-	-	-	-	40	-	100	4	4	4	6	6	
Registration Area		370	34	-	-	-	-	-	-	-	-	-	-	-	-	-	
Additional Options																	
Open Air Courtyard		7,730	718	-	-	-	-	-	-	-	400	-	-	-	-	-	
Upper Pavilion	59' x 65'	3,875	360	-	-	-	-	-	250	-	375	19	24	27	54	36	

LEVEL TWO

24,500 Sq Ft / 2,276 Sq M | 9 Rooms



VICTORIA
CONFERENCE
CENTRE

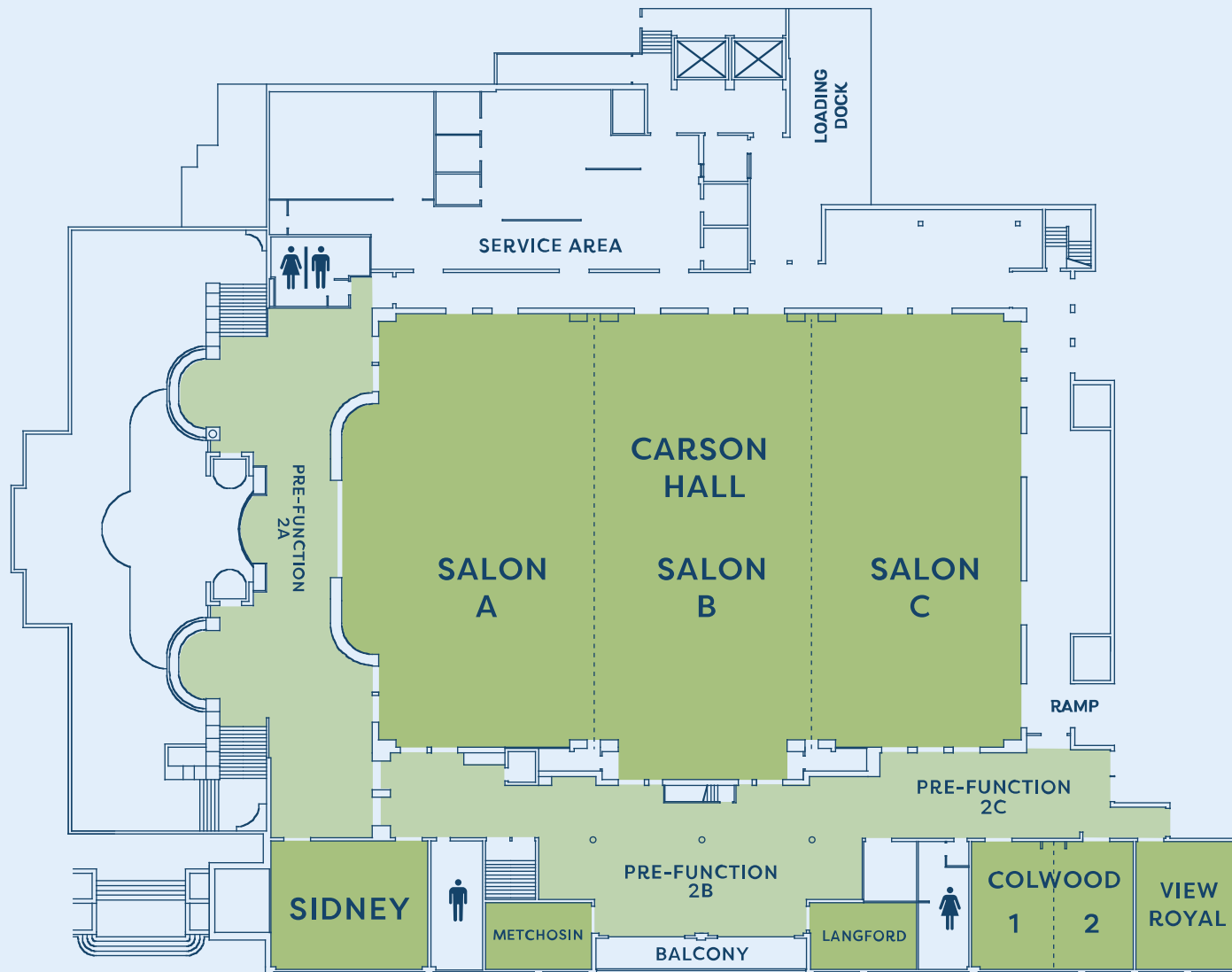

NOT TO SCALE

Room Name	Ft/In	Area Sq Ft	Area Sq M	Theatre	Classroom	Boardroom	Hollow Sq	U-Shape	Banquet	Cabaret	Reception	10x10	8x10	8x8	Tabletops	Poster Brd
Included in the Level Two Booking																
Carson Hall	145' x 96' x 23'	14,689	1365	1,500	816	-	138	111	1,010	-	2,000	80	102	122	190	166
Salon A	96' x 48' x 23'	5,056	470	500	264	-	82	68	370	246	600	29	30	38	56	55
Salon B	96' x 49' x 23'	5,025	466	494	270	-	82	68	340	228	600	25	34	42	64	53
Salon C	96' x 48' x 23'	4,608	428	468	294	-	82	68	320	216	600	23	32	39	63	50
Salon A + B	97' x 96' x 23'	10,081	936	1,053	588	-	112	81	740	462	1,200	61	68	86	134	118
Salon B + C	97' x 96' x 23'	9,633	895	1,008	540	-	112	81	730	444	1,200	56	62	81	130	113
Sidney	35' x 27' x 10'	945	88	85	60	28	42	34	60	36	110	4	4	6	11	10
Metchosin	24' x 15' x 9'	360	34	30	18	20	-	-	20	12	30	-	-	-	-	4
Langford	24' x 15' x 9'	360	34	30	18	20	-	-	20	12	30	-	-	-	-	4
Colwood	35' x 27' x 10'6"	945	88	85	60	28	42	34	60	36	110	4	4	6	10	10
Colwood 1	27' x 17'5" x 10'6"	472	44	48	24	20	24	22	30	18	50	2	2	3	7	4
Colwood 2	27' x 17'5" x 10'6"	472	44	48	24	20	24	22	30	18	50	2	2	3	7	4
View Royal	28' x 24' x 9'	672	63	60	36	20	32	22	40	24	60	3	3	5	7	8
Pre-function 2		6,880	640	-	-	-	-	-	170	-	800	13	16	17	41	37
Pre-function 2A		2,900	269	-	-	-	-	-	90	-	400	7	9	9	18	19
Pre-function 2B + C		3,980	370	-	-	-	-	-	80	-	400	6	7	8	23	18

CRYSTAL GARDEN

25,000 Sq Ft / 2,322 Sq M

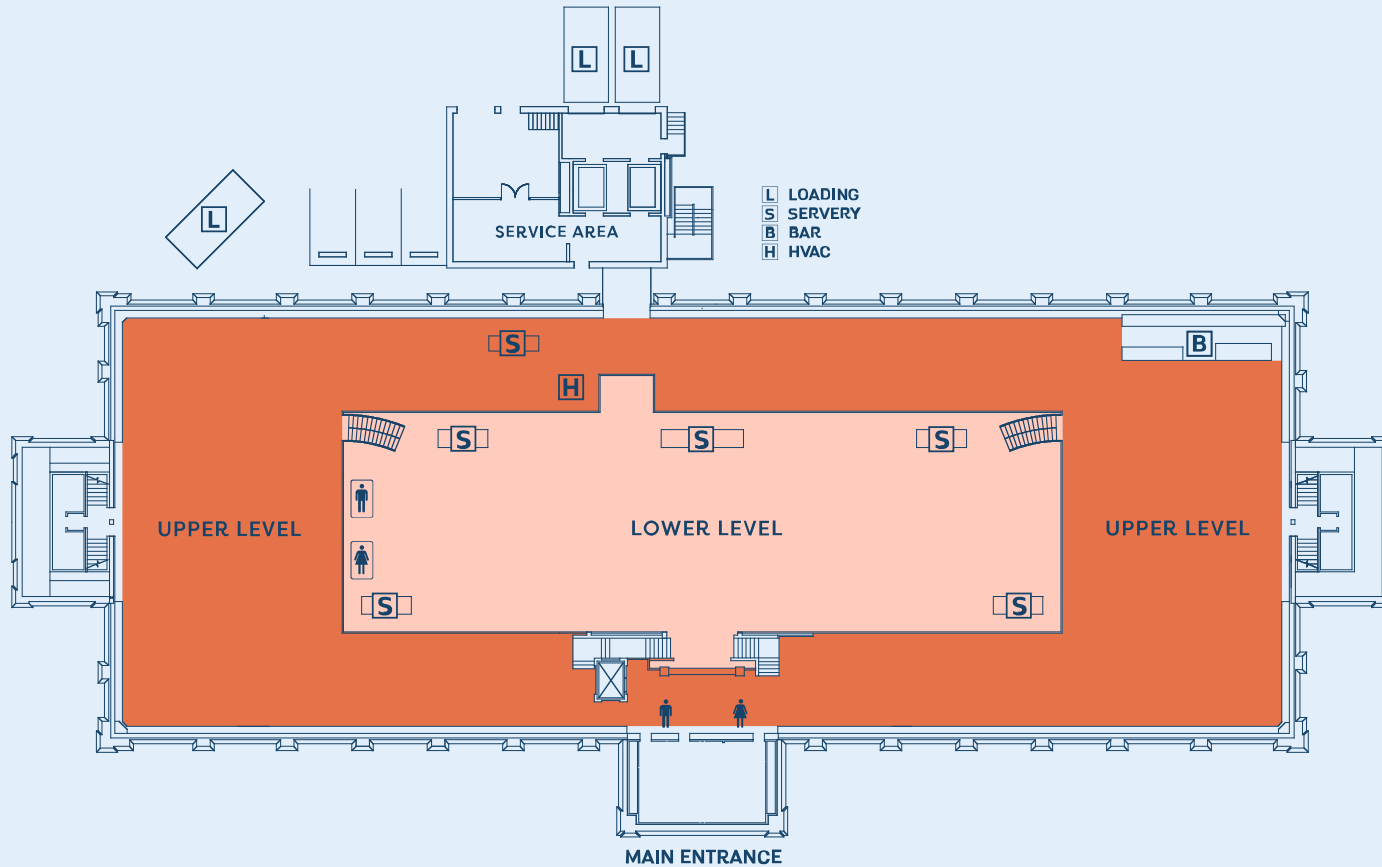

NOT TO SCALE

Room Name	Area Sq Ft	Area Sq M	Ceiling Height	Banquet	Reception	10x10	8x10	8x8	Tabletops	Poster Brd
-----------	------------	-----------	----------------	---------	-----------	-------	------	-----	-----------	------------

Included in the Crystal Garden Booking

Crystal Garden	25,000	2,322		1,100	1,100	81	98	124	255	150
Upper Level	16,196	1,505	To truss 13'	700	700	55	55	69	163	75
Lower Level	7,632	709	To truss 22'	400	400	26	43	55	92	75
Foyer/Entrance	1,172	108		-	-	-	-	-	-	-



victoriainconference.com
720 Douglas St, Victoria, BC V8W 3M7, Canada

BUSINESS EVENTS
VICTORIA
BC, CANADA

 **VICTORIA
CONFERENCE
CENTRE**